

# Hillsdale Heights Apartments

- ◆ Very spacious, well-designed floor plans
  - ◆ Washing machine and dryer in every unit for 1 & 2 bedrooms
  - ◆ Built-in microwave, dishwasher, and garbage disposal
  - ◆ Lots of windows and closets for ample storage
  - ◆ Short walking distance to excellent restaurants, shopping, and schools
  - ◆ Enjoy the year-round local Farmer's Market
  - ◆ Convenient access to Tri-Met bus lines 44, 45, 54, 55, 56, and express transit
  - ◆ Only minutes away from downtown Portland and freeways
  - ◆ No pets allowed to maintain a peaceful environment
  - ◆ Locally owned and operated for personalized service
  - ◆ Large secondary vehicle parking lot on site, eliminating the need to park on the public street
- ◆ **One free assigned covered parking space for each apartment**
  - ◆ **We cover water, sewer, and garbage expenses; no extra utility fees assessed**

## TYPE "A"

807 SF, 1 Bed-1 Bath,  
Bottom Floor \$1,350.00  
Middle Floor \$1,375.00  
Top Floor\* \$1,400.00

## TYPE "B"

1077 SF, 2 Bed-2 Bath  
Bottom Floor \$1,650.00  
Middle Floor \$1,675.00  
Top Floor\*\* \$1,700.00

## TYPE "C"

979 SF, 2 Bed-2 Bath  
Bottom Floor \$1,575.00  
Top Floor \$1,600.00

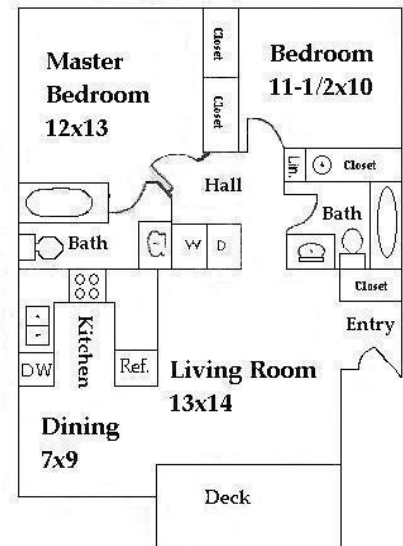

\*\*Wood-burning fireplace and vaulted ceilings

\* Vaulted ceilings

- Application Fee: \$75.00 Per Person (Non-refundable)
- Security Deposit: \$500 - 1 month rent \* Depending on credit
  - Additional Security Deposit Due to Risk Factors:
    - Up to ½ month rent. \* Depending on credit
- Lease terms: 1 Year

### Office Hours

MON to FRI: 11:00am to 4:00pm

*\*If you would like to make an appointment  
Please call: (503)293-0280*

*\*Messages are checked daily.*