

Hillsdale Heights Apartments

- ◆ Very spacious, well-designed floor plans
- ◆ Washing machine and dryer in every unit- 1 & 2 bedrooms
- ◆ Built-in microwave, dishwasher and garbage disposal
- ◆ Lots of windows and closets
- ◆ Short walking distance to great restaurants, shopping and schools
- ◆ Year-round local Farmer's Market
- ◆ Tri-Met bus lines 44, 45, 54, 55, 56 and express transit
- ◆ Only minutes to downtown Portland and freeways
- ◆ No pets allowed
- ◆ Locally owned and operated
- ◆ Large secondary vehicle parking lot on site- no need to park on the public street

- ◆ **One free assigned covered parking space**
- ◆ **We pay water, sewer and garbage- no extra utility fees assessed**

TYPE "A"
 807 SF, 1 Bed-1 Bath,
 Bottom Floor \$1,250.00
 Middle Floor \$1,275.00
 Top Floor* \$1,295.00

TYPE "B"
 1077 SF, 2 Bed-2 Bath
 Bottom Floor \$1,550.00
 Middle Floor \$1,575.00
 Top Floor** \$1,595.00

TYPE "C"
 979 SF, 2 Bed-2 Bath
 Bottom Floor \$1,475.00
 Top Floor \$1,500.00

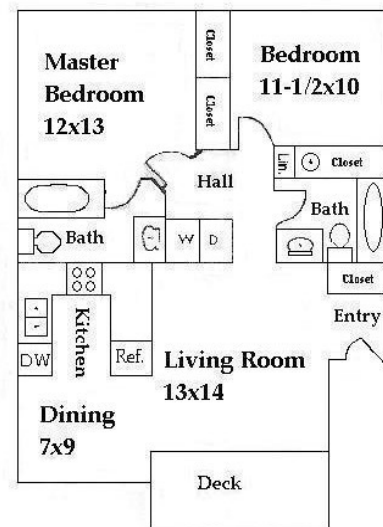

- **Wood-burning fireplace and vaulted ceilings
- * Vaulted ceilings

- Application Fee: \$75.00 Per Person (Non-refundable)
- Security Deposit: \$500 - 1 month rent * Depending on credit
 - Additional Security Deposit Due to Risk Factors:
 - Up to ½ month rent. * Depending on credit
- Lease terms: 1 Year

Office Hours

MON to FRI: 11:00am to 4:00pm

**If you would like to make an appointment
 Please call: (503)293-0280*

**Messages are checked daily.*