

Hillsdale Heights Apartments

- ◆ Spacious, well-designed floor plans
- ◆ A washing machine and dryer in every unit
- ◆ Built-in microwave, dishwashers and garbage disposals
- ◆ Lots of windows and closets
- ◆ Short walking distance to great restaurants, shopping and schools
- ◆ Year-round local Farmer's Market
- ◆ Tri-Met bus lines 44, 45, 54, 55, 56 and express transit
- ◆ Only minutes to downtown and freeways
- ◆ Built in 1992, with European style cabinets
- ◆ Assigned covered parking space
- ◆ No Pets Allowed
- ◆ **We pay water, sewer and garbage**

TYPE "A"

807 SF, 1 Bed-1 Bath,
Bottom Floor \$1,025.00
Middle Floor \$1,050.00
Top Floor* \$1,075.00



TYPE "B"

1077 SF, 2 Bed-2 Bath
Bottom Floor \$1,325.00
Middle Floor \$1,350.00
Top Floor** \$1,375.00



TYPE "C"

979 SF, 2 Bed-2 Bath
Bottom Floor \$1,225.00
Top Floor \$1,250.00

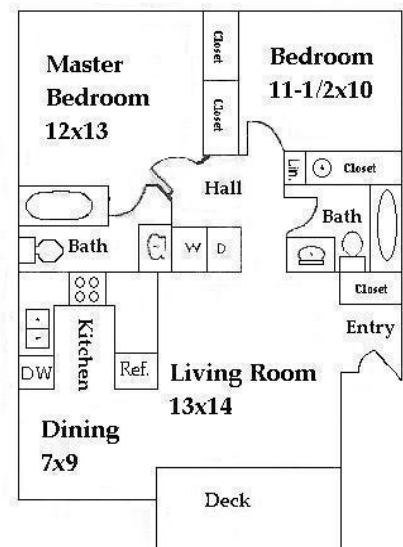

**Wood-burning fireplace and vaulted ceilings

* Vaulted ceilings

Application Fee: \$75.00 Per Person (Non-refundable)

Security Deposit: \$300 - 1 ½ month rent * Depending on credit

Cleaning Deposit: \$300.00

Lease terms: 1 Year

Office Hours

MON to FRI: 12:00pm to 5:00pm

**If you would like to make an appointment
Please call: (503)293-0280*

**Messages are checked daily.*